

One of America's most popular sump pumps, the Zoeller M-53 sump pump is known for reliability, durability and performance. Available with an integral 2-pole snap-action float switch. The heat-dissipating cast iron body with powder coated epoxy finish provides maximum pumping performance under the most extreme conditions. With Zoeller's cool run design, the hermetically sealed, oil-filled motor and non-clogging vortex impeller add up to a long-lasting, trouble-free product.



- Cast iron switch case, motor & pump housing
- Engineered thermoplastic base
- Engineered, glass-filled, plastic impeller with metal insert
- Stainless steel guard and handle
- Cast iron sleeve bearings

## Features:

- Float-operated, submersible, 2-pole mechanical switch & variable level, long-cycle systems available
- Corrosion-resistant, powder-coated epoxy finish
- No sheet metal parts to rust or corrode
- Stainless steel screws, switch arm, guard, and handle
- No screens to clog
- Watertight, neoprene square ring between motor and pump housing
- Solid, buoyant, polypropylene float
- Oil-filled, hermetically-sealed, automatic reset thermal overload protected motor
- Upper & lower sleeve bearings running in oil bath
- Entire unit pressure-tested after assembly
- Carbon and ceramic shaft seal
- Maximum temperature for effluent or dewatering: 130 °F (54 °C)
- Passes 1/2" (13 mm) spherical solids
- 1-1/2" NPT discharge
- On point: 7-1/4" (18 cm)
- Off point: 3" (8 cm)
- Major width: 10-3/32" (26.2 cm)
- Major height: 10-1/16" (25.6 cm)
- Watertight and dust-tight
- 3 year limited warranty

## Model 53® Features:

- 3-year warranty
- 3/10 HP 115 V sump pump; 230 V also available
- Performance up to 19.25' (5.9 m)
- Flows up to 43 GPM (163 LPM)
- Cast iron case cover, base, motor and pump housing
- Engineered thermoplastic base
- Corrosion-resistant, powder coated epoxy paint



**100% factory tested**

### PRODUCT SPECIFICATIONS

MOTOR	Horse Power	3/10
	Voltage	115 or 230
	Phase	1 Ph
	Hertz	60 Hz
	RPM	1550
	Type	Shaded pole
	Insulation	Class B
	Amps	4.8 - 9.7
PUMP	Operation	Automatic or nonautomatic
	Auto On/Off Points	7-1/4" (18.4 cm) / 3" (7.6 cm)
	Discharge Size	1-1/2" NPT
	Solids Handling	1/2" (12 mm) spherical solids
	Cord Length	9' (3 m) automatic, 15' (5 m) nonautomatic
	Cord Type	UL listed, 3-wire, grounded plug
	Max. Head	19.25' (5.9 m)
	Max. Flow Rate	43 GPM (163 LPM)
	Max. Operating Temp.	130 °F (54 °C)
	Cooling	Oil filled
	Motor Protection	Auto reset thermal overload
MATERIALS	Cap	Cast iron or bronze
	Motor Housing	Cast iron or bronze
	Pump Housing	Cast iron or bronze
	Base	Cast iron, bronze or engineered thermoplastic
	Upper Bearing	Sleeve bearing
	Lower Bearing	Sleeve bearing
	Mechanical Seals	Carbon and ceramic
	Impeller Type	Non-clogging vortex
	Impeller	Plastic, cast iron or bronze
	Hardware	Stainless steel
	Motor Shaft	AISI 1215 cold rolled steel
	Gasket	Neoprene

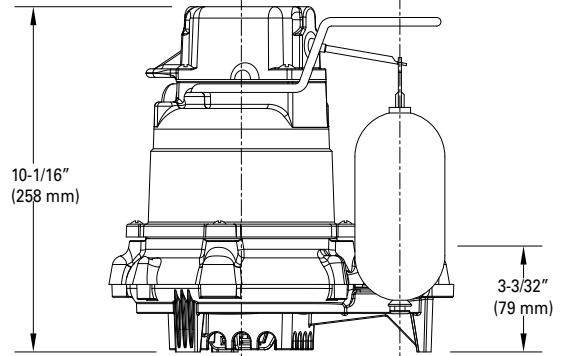
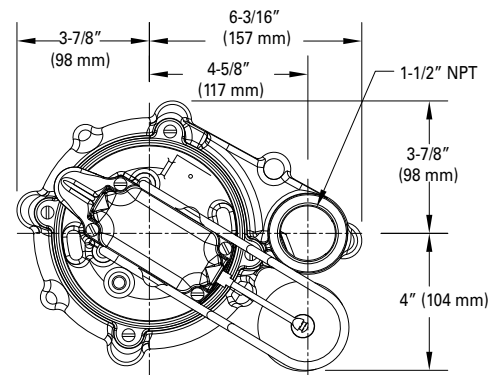

SK858

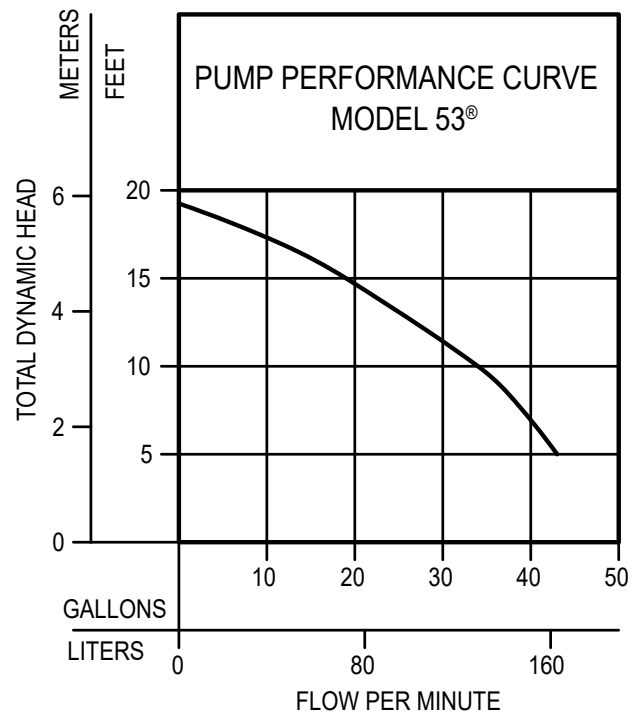

NOTE: See model comparison chart for specific details.



FM2958  
0123  
Supersedes  
0720

**CAUTION** All installation of controls, protection devices and wiring should be done by a qualified licensed electrician. All electrical and safety codes should be followed including the most recent National Electrical Code (NEC) and the Occupational Safety and Health Act (OSHA).